

**Flat Series Ventilator Unit VF 408**  
**Size: 4**

**Power Supply: 400V/3N~ 50Hz with**

**Pressure/Air Volume Performance, Selection of Speed Controllers**

**FISCHBACH**  
**COMPACT**  
**FAN**  
**CFE930/D1**

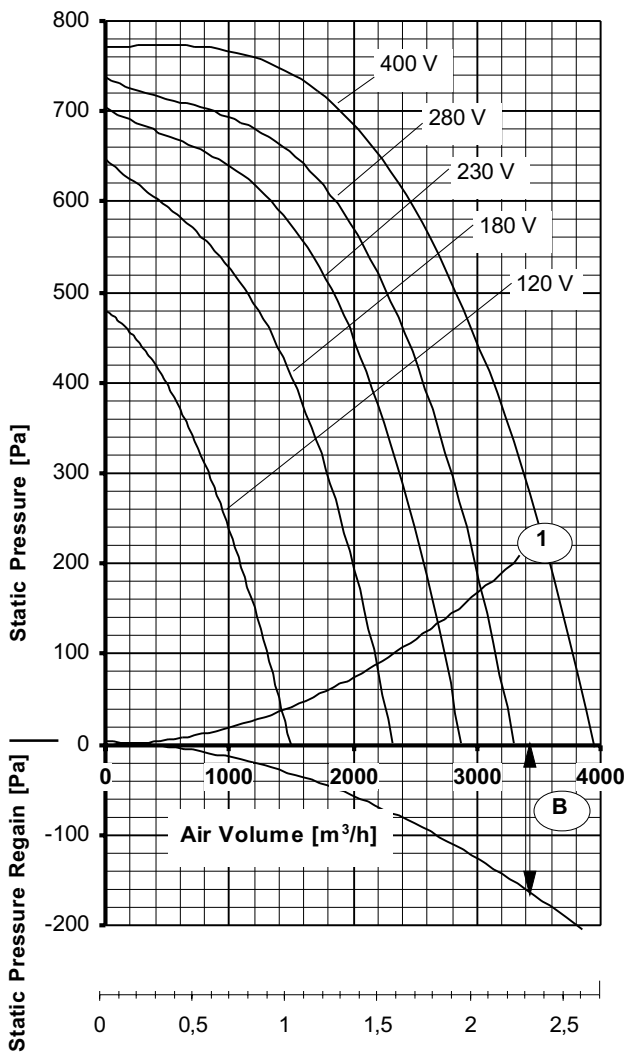
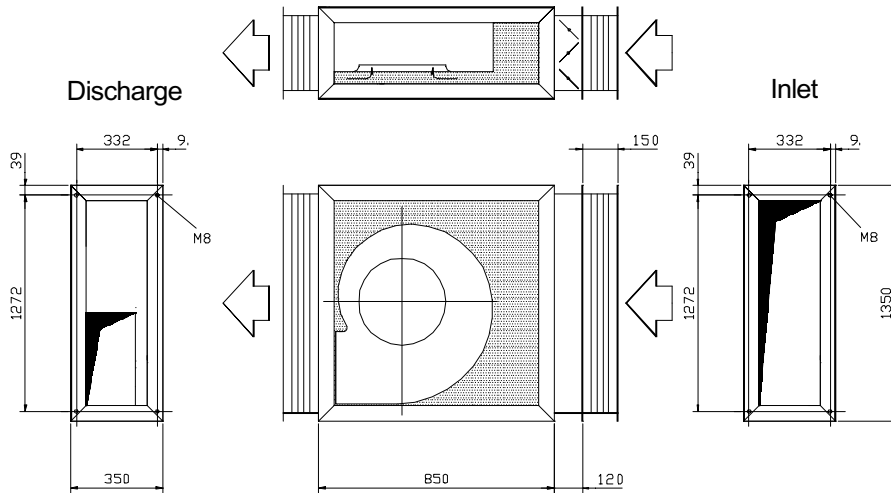

➔ Average Discharge-Air-Velocity  $\bar{v}$  [m/s], related to standard connection size A

**Max. permissible Air Inlet Temperature:**  
**At free air up to system curve (1): 50°C**  
**Above system curve (1): 60°C**

The data for external static pressure take into account all pressure losses due to integration of the fan within unit. Performance based upon free inlet and discharge.

**Max. power consumption 2,60 kW**

**Max. current consumption 5,80 A**

**$I_A / I_N$ : 1,9**

Static Pressure Regain (B) can be read from the performance curve. It is available when the unit is fitted with a straight discharge duct, sized according to the standard connection size A. Minimum duct length necessary: 2,0 m.

Voltage [V]	At free air [m³/h]	External static pressure $\Delta p_{st}$ [Pa] available for AHU and system pressure losses						
		100	200	300	400	500	600	700
		1st. line: Air Volume $V_L$ [m³/h] at $\rho = 1,2 \text{ kg/m}^3$ 2nd. line: Current consumption [A]						
120	1500 3,38	1310 3,10	1090 2,81					
180	2320 4,32	2170 4,06	2000 3,78	1790 3,46	1525 3,09	1145 2,63	450 2,03	
230	2880 4,75	2735 4,50	2570 4,23	2380 3,93	2145 3,60	1835 3,20	1345 2,68	
280	3305 4,91	3155 4,70	2985 4,47	2795 4,23	2565 3,95	2275 3,64	1860 3,25	870 2,59
400	3945 5,74	3775 5,58	3585 5,43	3375 5,26	3130 5,08	2840 4,89	2465 4,67	1900 4,42

**Save power and even more silent with FISCHBACH SPEED CONTROLLERS**

Voltage Control / Frequency Control	Type	Order-No.
Stepless, 0 - 100 % and 100 - 0 % *	FDR 80/3	6232
Stepwise, 5 Steps *	FDR 5.5/3	6182
FISCHBACH AUTOMATIC CONTROL *	FRA 80/3	6282
Frequency Inverter *	FFU 80	6301

\* with integrated motor protection and outlet fuses